

SMD POWER INDUCTORS: HSC0620 Series

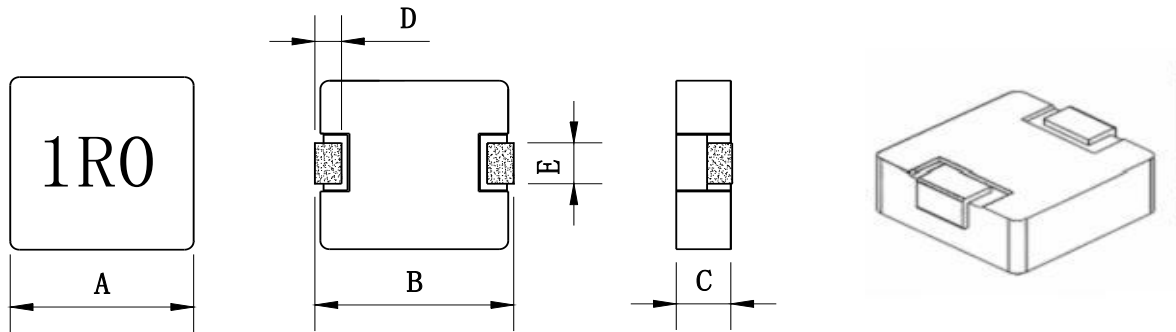

Series	A (mm)	B (mm)	C (mm)	D (mm)	E (mm)
HSC6020	6.6 ± 0.2	7.4MAX	2.0MAX	1.6 ± 0.3	3.0 ± 0.2

Part Number	L0 Inductance (μH) ±20%	Heat Rating Current Irms (A)	Saturation Current Isat (A)	DCR (mΩ)	
				TYP.	MAX.
HSC6020-2R2M-G/B	2.2	4.0	8.0	44.0	48.0
HSC6020-3R3M-G/B	3.3	3.5	7.5	66.0	74.0
HSC6020-4R7M-G/B	4.7	2.5	4.0	87.0	105.0
HSC6020-6R8M-G/B	6.8	1.8	3.0	120.0	130.0

*: you require another part number please contact with us.

** : Inductance Tolerance ± 20%

Note 1: All test data is referenced to 25°C ambient.

Note 2: Idc : DC current (A) that will cause an approximate ΔT of 40°C

Note 3: Isat : DC current (A) that will cause Lo to drop approximately 30%

SMD POWER INDUCTORS:

HSC-6018M Series

1. Reel Dimension

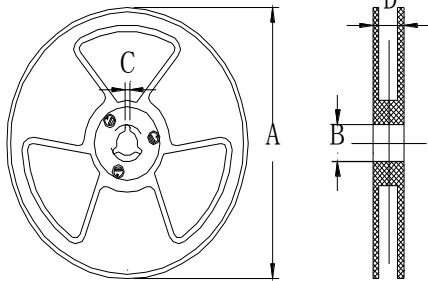

规格 尺寸	13"
A	$\Phi 330 \pm 2.0\text{mm}$
B	$\Phi 76.5 \pm 2.0\text{mm}$
C	2.3mm
D	16mm (载带 $13.3 \pm 0.15\text{mm}$)

2. Tape Dimension

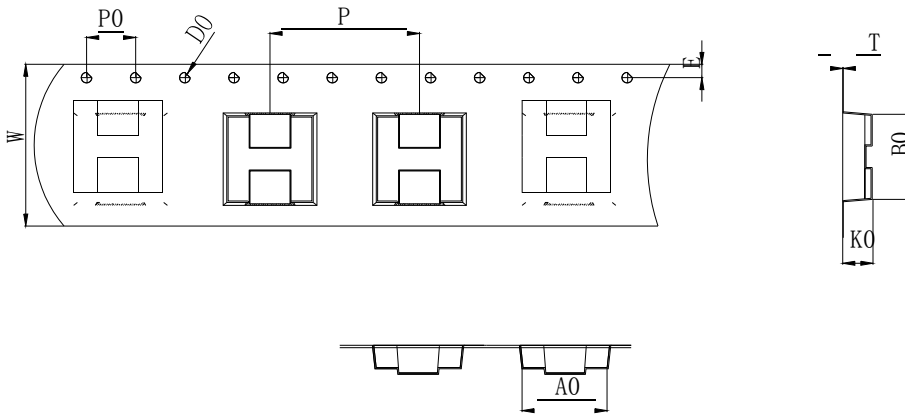

Size	W (mm)	A0 (mm)	B0 (mm)	D0 (mm)	E (mm)	K0 (mm)	P0 (mm)	P (mm)	T (mm)
601	16.0 ± 0.3	6.8 ± 0.1	7.3 ± 0.1	1.5 ± 0.1	1.75 ± 0.1	1.8 ± 0.1	4.0 ± 0.1	12.0 ± 0.1	0.3 ± 0.05

3. Packaing Quantity

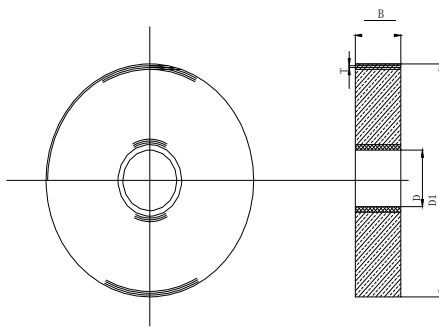

包装单位	包装尺寸	包装数量
1 盘	330*29mm	3000pcs
1 盒3 盘	34*6.5*34cm	9000pcs
1 箱2 盒	35.5*28.5*36.5cm	18000pcs