

SMD POWER INDUCTORS: HSC5020 Series

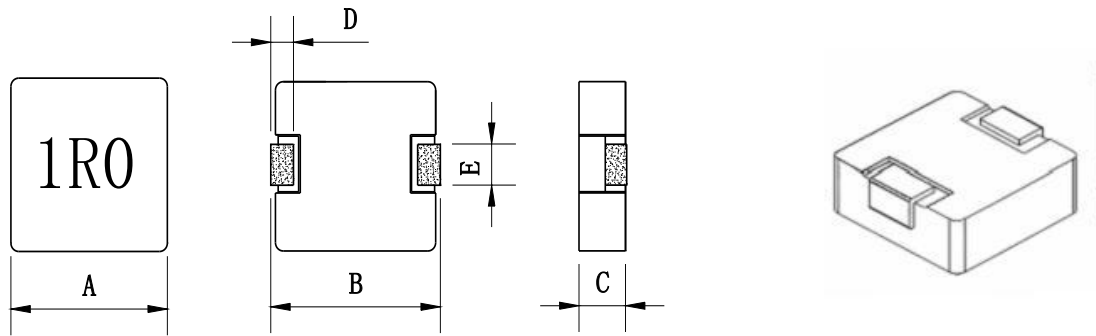

Series	A (mm)	B (mm)	C (mm)	D (mm)	E (mm)
HSC5020	5.18 ± 0.3	5.45 ± 0.4	2.0MAX	1.2 ± 0.3	2.3 ± 0.2

Part Number	L0 Inductance (µH) ± 20%	Heat Rating Current Irms (A)	Saturation Current Isat (A)	DCR (mΩ)	
				TYP.	MAX.
HSC5020-R10M-G/B	0.1	14.0	25.0	2.1	2.7
HSC5020-R22M-G/B	0.22	10.0	18.0	3.9	4.5
HSC5020-R33M-G/B	0.33	7.5	13	5.5	6.2
HSC5020-R47M-G/B	0.47	8.0	12.5	6.4	7.1
HSC5020-1R0M-G/B	1	6.0	9.0	16.8	18.1
HSC5020-2R2M-G/B	2.2	4.5	8.0	26.7	30.6
HSC5020-3R3M-G/B	3.3	3.5	5.5	62.5	75.0
HSC5020-4R7M-G/B	4.7	3.0	5.0	74	82
HSC5020-5R6M-G/B	5.6	2.5	5.0	84.0	92.0
HSC5020-6R8M-G/B	6.8	2.2	4.5	114	134.0
HSC5020-100M-G/B	10.0	2.0	4.0	200.0	220.0

*: you require another part number please contact with us.

** : Inductance Tolerance ± 20%

Note 1: All test data is referenced to 25°C ambient.

Note 2: Idc : DC current (A) that will cause an approximate ΔT of 40°C

Note 3: Isat : DC current (A) that will cause Lo to drop approximately 30%

SMD POWER INDUCTORS:

HSC-5020M Series

1. Reel Dimension

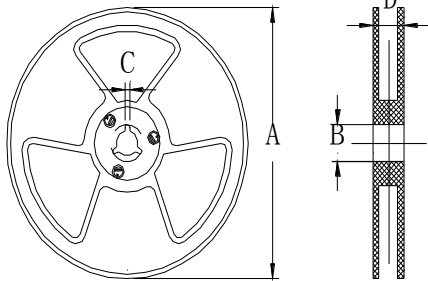

规格尺寸	13"
A	$\Phi 330 \pm 2.0\text{mm}$
B	$\Phi 76.5 \pm 2.0\text{mm}$
C	2.3mm
D	$12 \pm 0.2\text{mm}$ (载带 9.3mm)

2. Tape Dimension

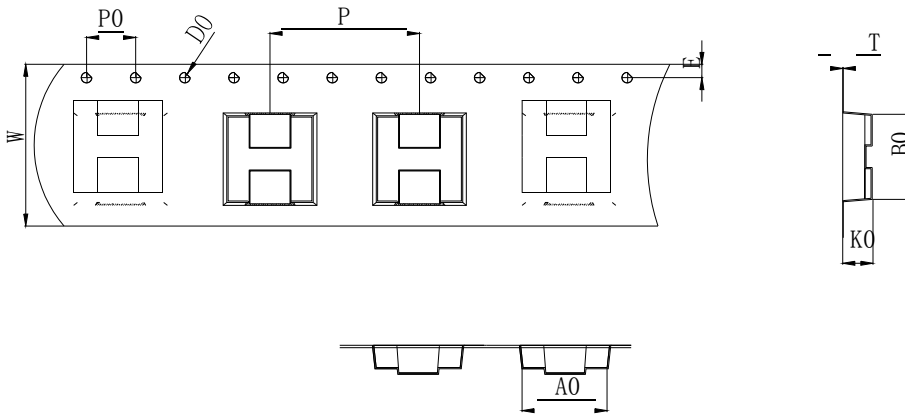

Size	W (mm)	A0 (mm)	B0 (mm)	D0 (mm)	E (mm)	K0 (mm)	P0 (mm)	P (mm)	T (mm)
5020	12.0 ± 0.3	5.5 ± 0.1	6.0 ± 0.1	1.5 ± 0.1	1.75 ± 0.1	2.0 ± 0.1	4.0 ± 0.1	8.0 ± 0.1	0.3 ± 0.05

3. Packaing Quantity

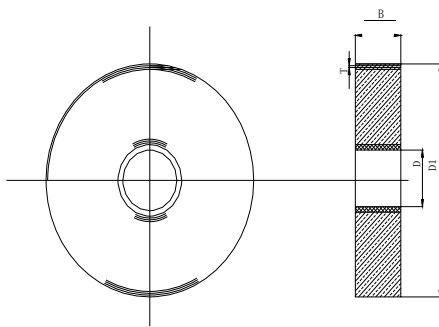

包装单位	包装尺寸	包装数量
1 盘	330*12.5mm	3000pcs
1 盒3 盘	34*6.5*34cm	90000pcs
1 箱2 盒	35.5*28.5*36.5cm	180000pcs